

MASTER HIRE
VACUUM KIT LIST FOR THE VC AND VCL VACUUMS

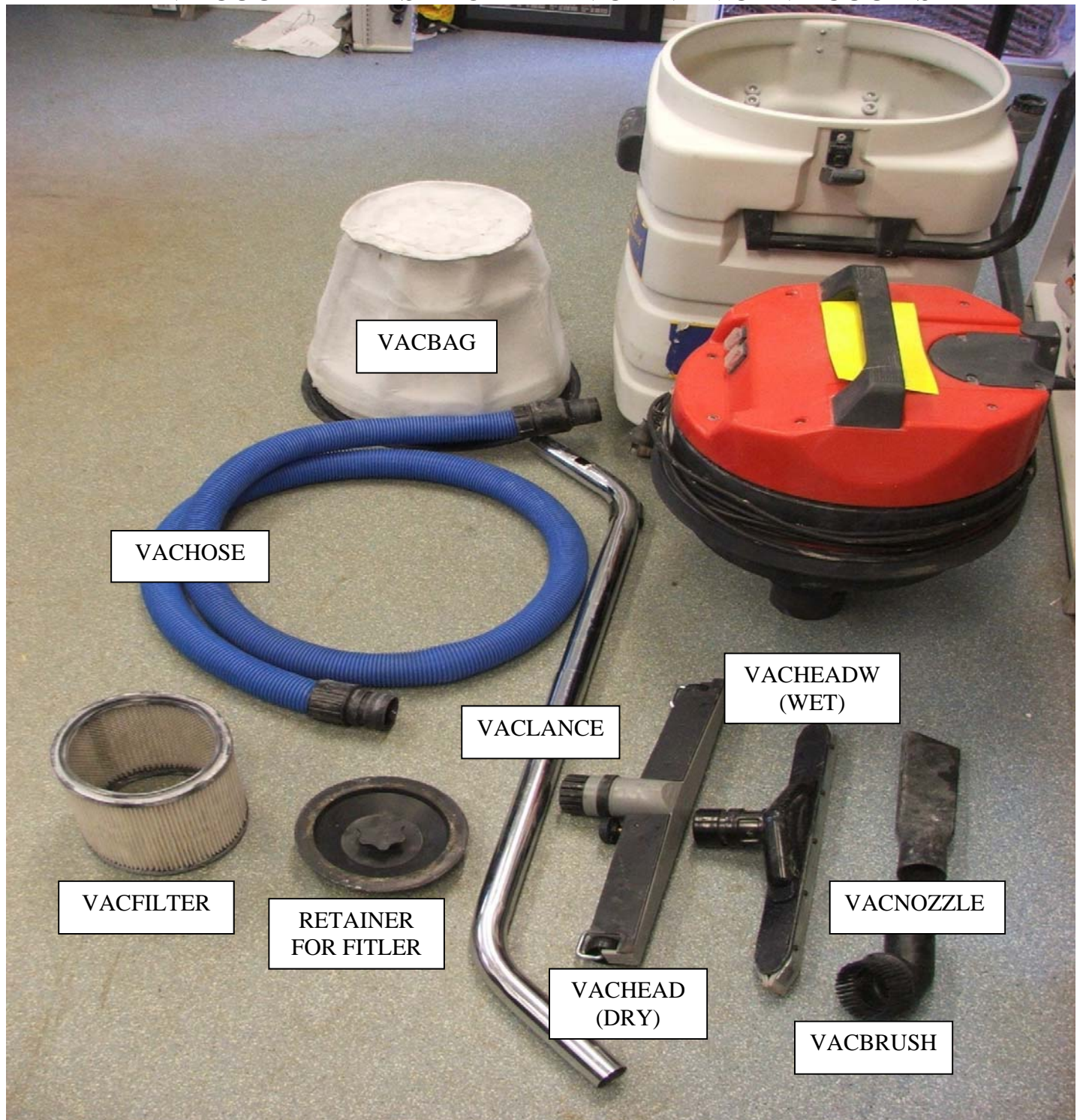

NOTE: VACFILTER AND RETAINER IS FITTED TO THE VACUUM CLEANER MOTOR HEAD UNIT AND NEEDS TO BE USED FOR WET AND DRY OPERATION

INTRODUCTION

Your new KERRICK Industrial Vacuum Cleaner is a wise investment. As a result of product development this equipment has quality; durability and consistency built into it, and properly treated will give many years of service.

You will get the best use from your KERRICK Vacuum if you follow the suggestions for maintenance contained within. Please read the user instructions and familiarise yourself with the features and operating details. If you have any special questions, write or phone us or contact your selling agent and we will be glad to help you. To avoid any delay in assisting you, please always quote the machine model and serial number. For information on

Dry vacuuming see pages 3-5.

Wet vacuuming see pages 6-10.

WARNING!

IMPORTANT SAFE GUARDS

Read these instructions carefully and keep them for reference purposes.

The packaging around the cleaner (plastic bags, clips, etc.) are potentially dangerous objects and should be kept out of reach of children and others not accountable for their own actions.

Once the cleaner has been taken out of the packaging, check that it is complete. If any doubt arises as to this point the cleaner should not be put into use, but you should contact your selling dealer - **Immediately.**

CAUTION!

- Prior to connecting the cleaner check that the specified mains voltage (see model plate) corresponds to the voltage available.
- The cleaner should only be used for the specified purposes nominated. Using the cleaner for other purposes is both incorrect and hazardous.
- When the cleaner has been connected and running the suction inlet hose and or accessories should not come close to sensitive parts of the body, such as eyes, mouth, ears, etc.
- The cleaner should never be left unattended in the presence of children or other persons not accountable for their own actions.
- When the cleaner is not in operation remember to switch it off.
- The cleaner should never be lifted by the electric cable, or be unplugged by pulling the cable.



- Check the cable prior to use. A Machine with a defective cable should never be used.
- The electrical cord should be kept dry and away from any moist surfaces.
- Remember to unplug from the power point prior to opening the cleaner for emptying or maintenance. The cleaner should never be immersed in water. Solvents or strong detergents should never be collected or used to clean the machine.

The manufacturer or supplier shall not be held responsible for any damage caused to persons, animals or objects due to incorrect or irrational use or non-observance of these instructions.

DRY VACUUMING MODELS

WARNING

**DRY VACUUM CLEANERS ONLY
THESE APPLIANCES ARE DOUBLE INSULATED AND
ARE FOR DRY USE ONLY**

THEY MUST NOT BE USED FOR WET COLLECTION APPLICATIONS

UNPACKING AND SETTING UP

Your KERRICK dry pick up vacuum cleaner comes complete with a full range of accessories designed to make your cleaning task an easy one.

1. Lift the vacuum out of the packing by means of the carry handle.
2. Insert the flexible hose (G) into the tank inlet (F) and press until you hear a click - lock.
3. Screw top wand (P) onto the suction hose.
4. Fit the two piece extension tube wand (M & O) together.
5. Fit the top curved wand (P) into extension tubes

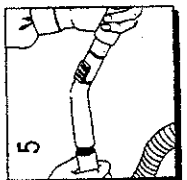
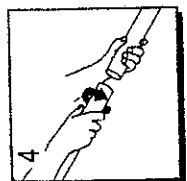
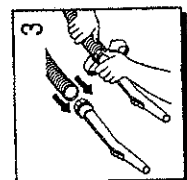
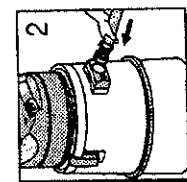
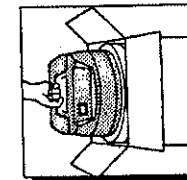

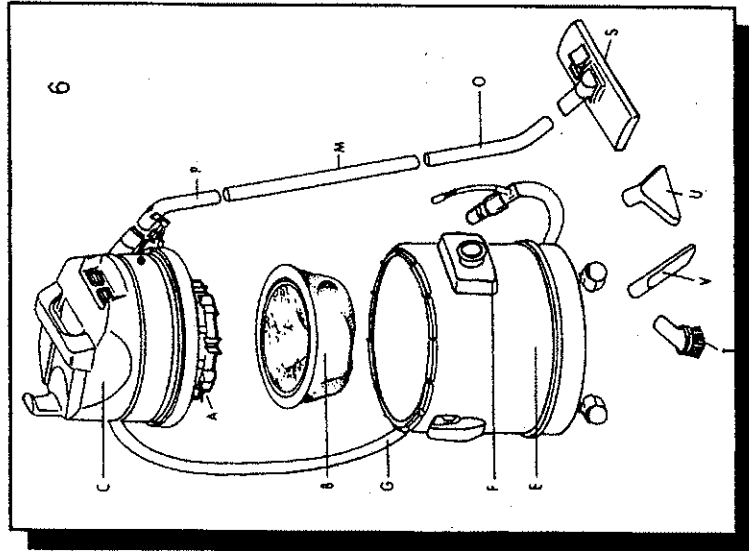

6. Select tool (S, T, U or V) to be used and fit it to lower end of the wand. Tools T - V & U can be fitted directly onto the curved wand (P) if required for confined area cleaning.

NOTE: The top curved wand has a grey suction control button, slide the button fully back for maximum suction. This knob allows the operator to vary the suction when vacuuming such things as curtains, upholstery, mats, carpet, tiles. To decrease suction slide the button forward.

6a. Ensure that fabric filter bag (B) and bag support ring are fitted into top of tank. Then fit vac head and attach clamps.

NOTE: The machines should never be used without a filter bag.

6b. Your KERRICK Vacuum Cleaner is designed to operate on 240 volt 50Hz 1 phase power - insert three pin plug into your power supply.

7. Switch on power point /switch on machine.

7a. Model Housekeeper has a one touch on/off switch. Push button in for on and out for off

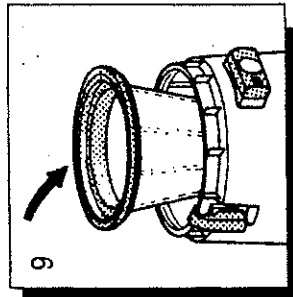
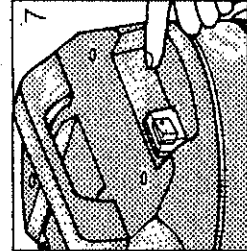
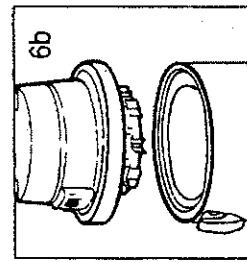
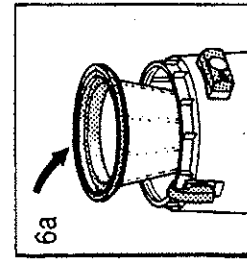

8. A build up of dust and solids on the filter bag will result in clogging of filter surface and place excessive load on the suction motor which could result in motor failure. Empty and clean filter bag after every use to ensure maximum operating efficiency. Machine wash and dry your filter bag regularly, replace your filter bag at least every 12 months.

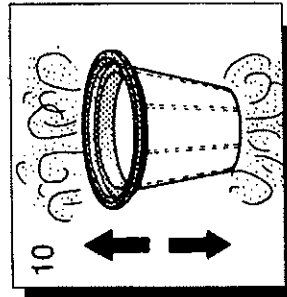

9. Debris can be emptied by removing the motor head and cloth filter bag (B), gently shake filter bag before removing it from tank. Carry tank (E) to disposal area and tip. Make sure no dust or dirt is inside filter bag.

10. Shake bag clean.

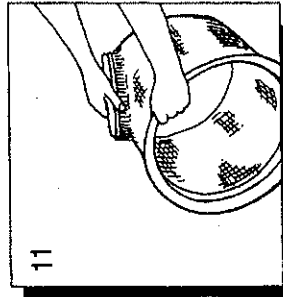

11. Then using a stiff brush thoroughly clean the filter bag surface. The filter bag can be removed from the filter ring and washed by hand or machine. Thoroughly dry filter bag prior to (12.) refitting to machine.

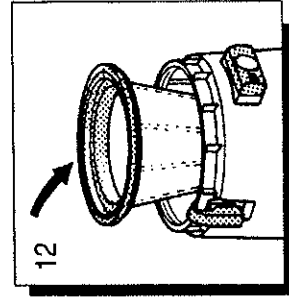

13. It is recommended that disposable paper filter bags are used when vacuuming fine dust, their use will assist in improving performance. Use paper filter bags (P/No. VP00147) to simplify machine emptying and cleaning. To fit paper filter bag No. VP00147 simply push cardboard bag support firmly over the internal tank inlet.

For Hospital - Housekeeper 103S - 203S -215S models use paper filter bag VP00147/2

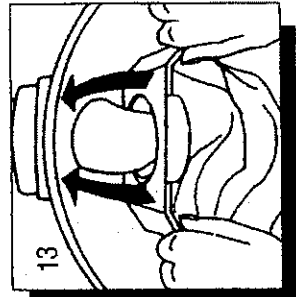

WET / DRY VACUUMING MODELS

THESE APPLIANCES MUST BE EARTHED

BEFORE SWITCHING ON MACHINE CHECK THAT THE VOLTAGE INDICATED ON THE RATING PLATE IS THE SAME AS YOUR POWER SUPPLY.

UNPACKING AND SETTING UP

Your KERRICK wet and dry pick up vacuum cleaner comes with a full range of accessories designed to make your cleaning task an easy one.

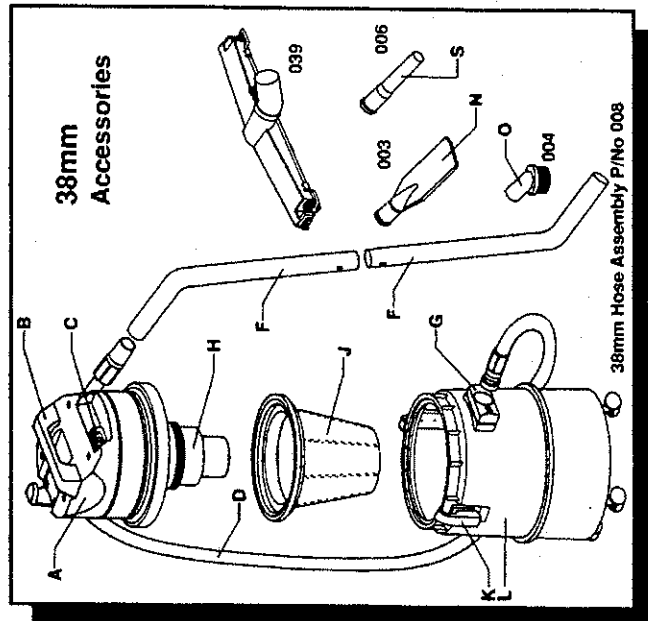

Schematic View Head - Tank and Tool Configuration

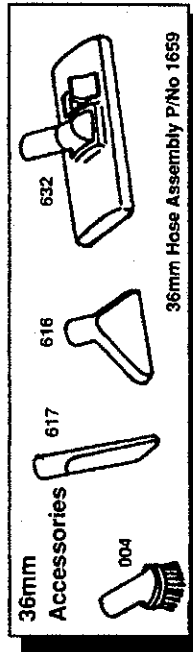

FOR ACCESSORY REORDER USE ABOVE P/No's

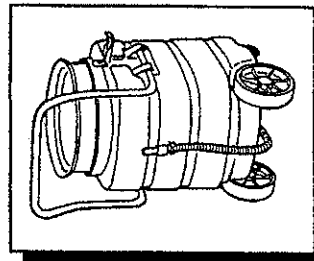

Ph Tank Model

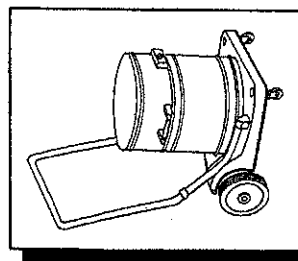

S / S Tank Model

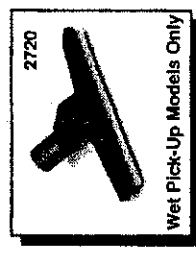

Wet Pick-Up Models Only

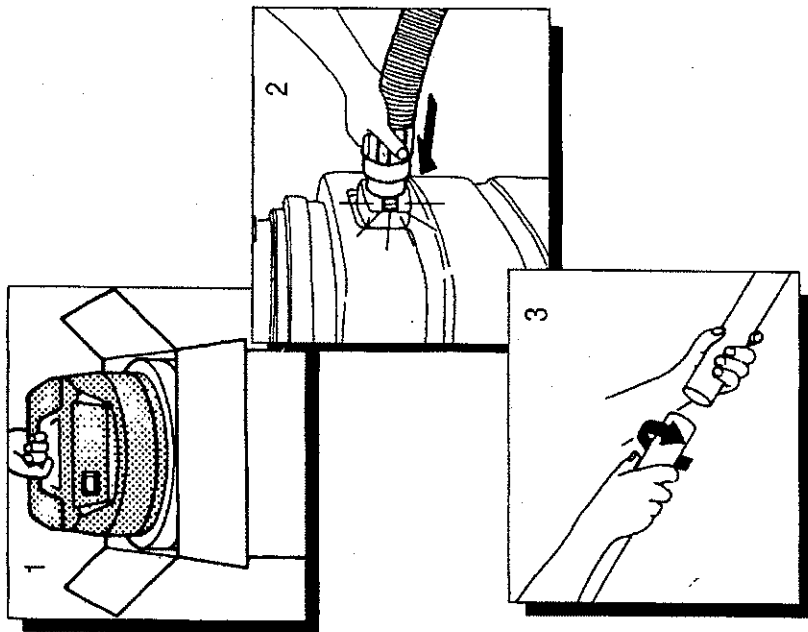

1. Lift the vacuum cleaner out of the packing by means of the carry handle (B) or with 400/600 series machines lay box on end and wheel machine from carton.
2. Insert the flexible hose (D) into the tank inlet (G) and press until you hear a click-lock.
3. For machines using 36mm tools follow instructions for assembly described on page 3 and 4.

For machines with 38mm tool sets fit the two piece extension tube set (F) together with the suction regulating hole on top.

NOTE:

Top extension tube has a black suction regulating control knob, turn knob fully to right (clockwise) for maximum suction. This knob allows the operator to vary the suction when vacuuming such things as curtains, upholstery, mats, carpet, tiles. To decrease suction turn knob left (anticlockwise).

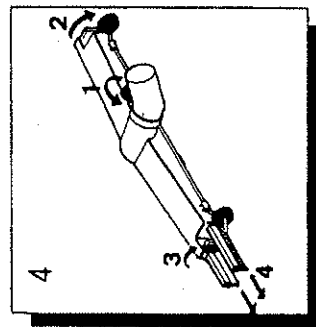

4. 38mm Wet / Dry models come complete with a multipurpose floor tool suitable for vacuuming hard floors and carpets both wet and dry. The tool (P / N VP 00039) can be adjusted to various cleaning jobs. The height adjustment is made by turning the thumb screw (1) until the wheels (2) hold the suction head on the required level. In order to exchange the inserts, loosen the thumb screw (1) so the wheel axle (2) can be swung up, (3) turn up the insert stop to the vertical position. The insert rails can now be exchanged.

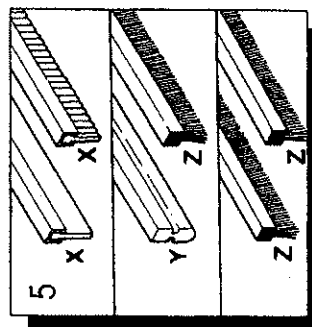

5. **WET VACUUM CLEANING**, mount the rubber rails (X) with the grooved sides outwards. For **CARPET VACUUM CLEANING** mount side rail (Y) in front and brush rail (Z) at the back. For **DRY VACUUM CLEANING** on smooth surfaces mount both brush rails (Z)

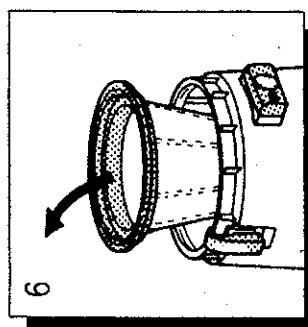

6. If you are using your KERRICK Vacuum Cleaner for **wet pick up** first ensure that the fabric filter and the fabric filter bag support **are removed** from the tank. Detach head clamps (K), lift head of tank, remove filter bag and support ring (J), replace head and re-attach clamps (K).

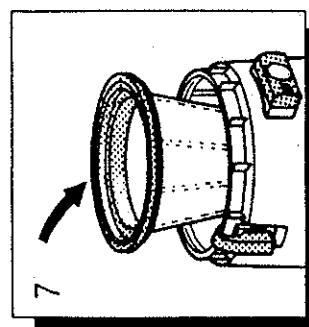

7. When using your machine for **dry pick up** ensure that the fabric filter bag is in place before use. **NOTE:** Failure to use the fabric filter bag during dry operation will result in motor failure due to clogging and overheating of the motor this will nullify motor warranty.

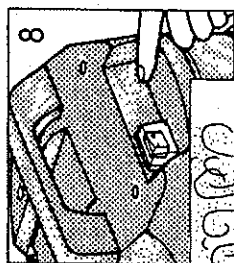

8. Your KERRICK Vacuum Cleaner is designed to operate on 240 volt 50Hz 1 phase power - insert three pin plug into your power supply. Switch on power point /switch on machine.

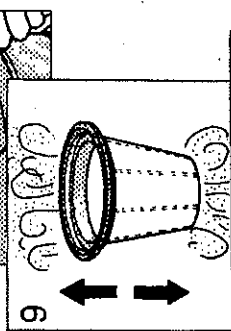

On 2 and 3 motor models, the suction power can be adjusted by turning 1, 2 or 3 motors on together or independently. It is important that machine tanks be emptied regularly, preferably after each use.

TO EMPTY AFTER DRY VACUUMING

9. Detach head clamps (K), remove head, remove fabric filter bag and support rings (J), shake bag clean (10) using a stiff brush thoroughly clean the filter bag surface. The filter bag can be removed from the filter ring and washed by hand or machine, thoroughly dry filter bag prior to refitting to machine. Fabric filter bags should be replaced at least every 12 months.

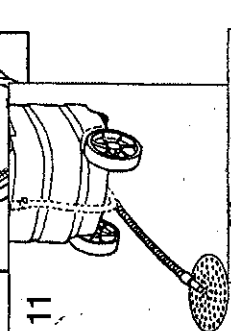
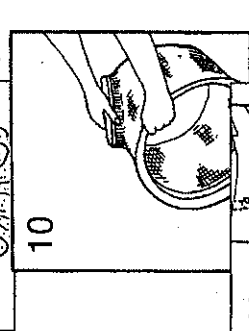

TO EMPTY AFTER WET VACUUMING

11. Detach head clamps (K), remove head, wheel tank to disposal area and tip fluid from tank. On certain PHD tank models, tank emptying can be quickly done using the tank drain hose.

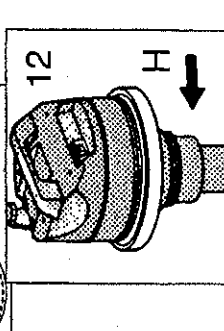

12. Dry tank thoroughly prior to re-assembly of machine.

The underside of the motor head is fitted with a float (H) which when wet vacuuming, prevents the container overfilling. The float also prevents the liquid from penetrating into the motor unit if the machine should tip over. In order to keep the machine in good operational condition the float (H) must be cleaned at regular intervals. After wet vacuuming, the tank, motor heads, and accessories should be cleaned and wiped dry.

NOTE: Please contact your nearest KERRICK branch or sales agent if further assistance is required.

If foam or liquid comes from machine exhaust (lower part of motor housing) switch off immediately by isolating at mains.

- i) Check float level device for cleanliness and correct operation.
- ii) Empty machine after isolating at mains socket then refill container with 1 litre of defoamer. Increase volume of defoamer if necessary.
- iii) Dry machine body with cloth before re-using.

MAINTENANCE INSTRUCTIONS

Maintenance of electrical components should only be carried out by a certified electrician otherwise return machine to your nearest KERRICK Branch Office or Kerrick Service Agent. **Never** carry out any repairs without first disconnecting machines from mains supply.

At regular intervals

A Check mains cable and plug for damage.

B Check machine for damage.

DAILY (Wet application machines only)

C Check for correct operation of high water level cut-off float device. Ensure float is free to operate and that the seat on the underside of the motor housing is in good condition, and the float gauze cage is clean, wash out tank with clean water after use. This prevents the building up of bacteria which could occur if machine is left uncleaned for long periods of time (prevents unpleasant odours from occurring).

D Check machine switch (s) for damage, ensure plastic switch cover is soundly in place, check that the filter bag is not clogged, replace filter bag every 12 months or when necessary in high use applications.

WEEKLY

E Check hoses, extension tubes, accessories for damage or blockage. (Unseen blockages sometimes occur, check thoroughly).

F Examine filter bag (replace or clean).

1000 HOURS OR 4 MONTHLY (IN ADDITION TO ABOVE)

G Examine vacuum motors for carbon brush wear. Remove all traces of carbon with fine dry brush. Ensure no traces of moisture are present.

H Carry out full electrical safety check.

Never use an air line for cleaning purposes unless fitted with a **moisture filter**.